



## Classic TBi 260

Air cooled

TBi-Flex rubber coaxial cable

Uses same gasnozzles as TBi 380 / 411 / 511

### Technical data

#### MIG / MAG (GMAW) Semi-automatic welding torch TBi 260

Rating at 60% duty cycle  
(10 min. cycle)

- Mixed gas: 240 A  
- CO<sub>2</sub>: 270 A

Cooling method Air cooling

Wire diameter 1.0 - 1.2 mm

Gas flow 12 l/min

Technical specification according to IEC 60974-7

Weight with 1.5m cable 1.55 kg

Connection Euro-Central connector  
other connectors are available upon request.

Torch rating will be reduced when using pulsed-arc power sources. Special torch necks and custom lengths of the coaxial cable are available upon request.

### Ordering Information

TBi 260 ESG, 50° bent 118P3413\_0\*

\* At the blank, please insert 3, 4 or 5 for a torch length of 3, 4 or 5m.

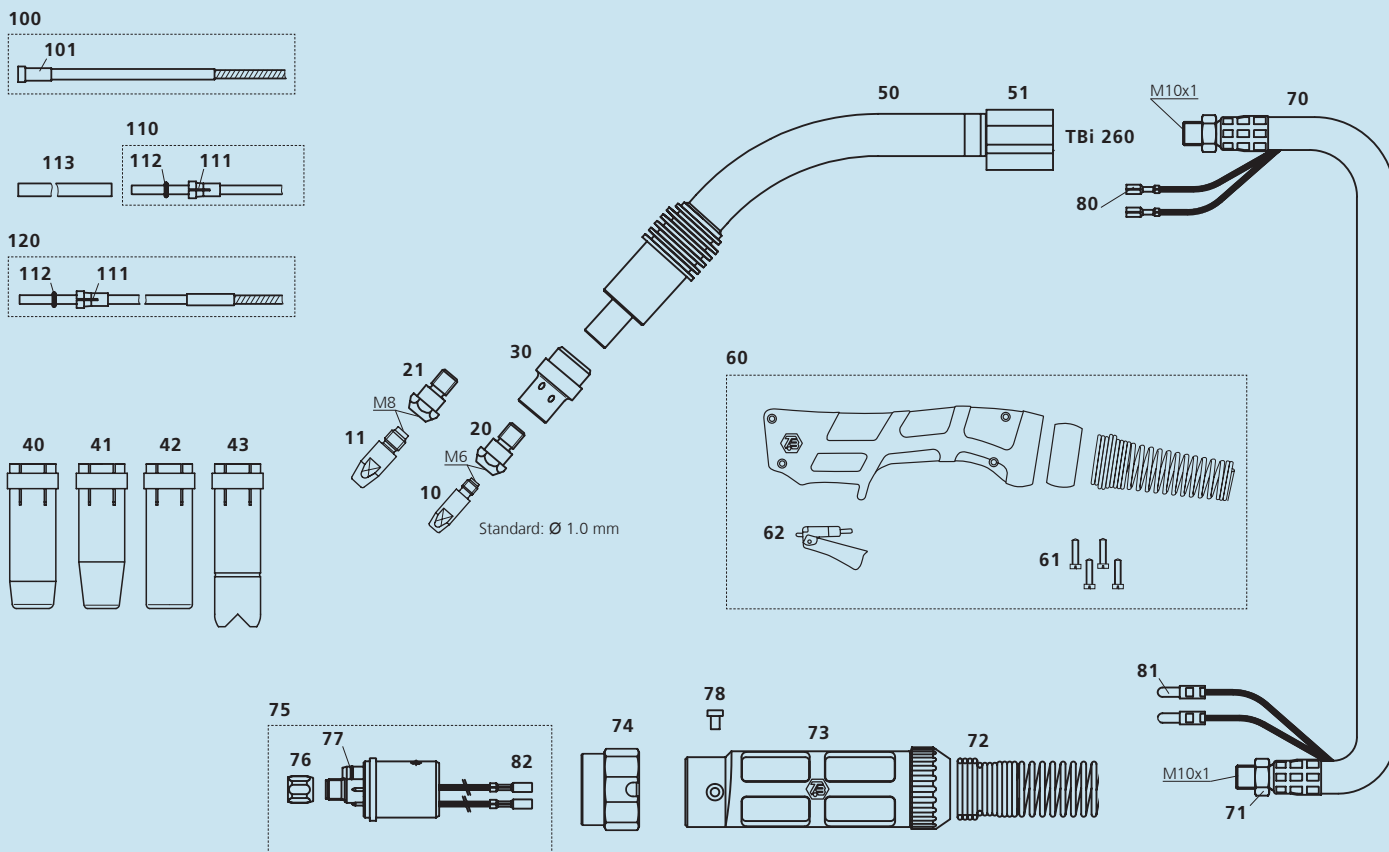

Pos. Description

Part. No.

#### Contact tips

▶ 10	<b>Contact tip M6x28, Ecu</b>	<b>340P_1069*</b>
10	Contact tip M6x28, CuCrZr	340P_3069*
10	Contact tip M6x28 Alu, Ecu	341P_1069*
11	Contact tip M8x30, Ecu	340P_1262*
11	Contact tip M8x30, CuCrZr	340P_3262*
11	Contact tip M8x30 Alu, Ecu	341P_1262*

#### Tip holders

▶ 20	<b>Tip holder M6 / L=22 mm</b>	<b>342P006018</b>
20	Tip holder M6 / L=25 mm	342P006118
21	Tip holder M8 / L=22 mm	342P008018

#### Gas diffusers

▶ 30	<b>Gas diffuser, black</b>	<b>118P002021</b>
------	----------------------------	-------------------

#### Gas nozzles

▶ 40	<b>Nozzle conical diam. 16 mm</b>	<b>345P012030</b>
41	Nozzle conical diam. 14 mm	345P013030
42	Nozzle conical diam. 20 mm	345P011030
43	Spot weld nozzle diam. 20 mm	345P015030

#### Spare parts

50	Torch neck TBi 260, 50°	118P001020
51	PVC body	600P002018
60	Handle blue, aircooled, cpl. kit	380P220400
61	Cross recessed screw M 3.5x14	100P008413
62	Trigger, red, 2 poles	385P021016
70	TBi-Flex coaxial cable 35 sqmm	360P3511_0*
71	Hex nut M10x1	101P002005

Pos. Description

Part. No.

72	Spring support small 16-50 sqmm	600P102099
73	Cable support cpl. (2 pieces)	701P001045
74	Adaptor nut	701P001013
75	Central adaptor ESG cpl., 2 poles, moveable pins	701P001048
76	Sleeve nut M10x1	701P002005
77	O-ring 4.0x1.0 mm (gas nipple)	365P100040
78	Slotted screw M4x6	100P008401
80	Cable lug, flat	375P000023
81	Insulated connector, male, round	375P000004
82	Insulated connector, female, round	375P000003

#### Wire guides

▶ 100	<b>Liner w/ insulation red (x.40 m) for wire 1.0-1.2</b>	<b>324P2045_4*</b>
101	Collet for liners diam. 4.5 mm	330P025045
110	PTFE-liner red (x.50 m) for wire 1.0-1.2	326P2040_5*
111	Collet for liners 2.0x4.0 mm	331P020040
112	O-ring 3.50x1.50 mm (for liner)	365P150035
113	Support tube 5x4.4 mm, L=150 mm	329P544150
120	PA-Alu wire guide (x.50 m) for wire 1.0-1.2	328P2040_A*

▶ = Standard parts

\* At the blank, please insert suitable information for torch length or wire diameter, e.g. 08 for 0.8 mm or 3 for 3 mm.

© 2012 TBI Industries GmbH. All rights reserved. Subject to change without notice. Warranty only when using original TBI consumables and spare parts. Excerpts and reprints not permitted. Nr. DOKP111152, 12/2012.

TBI Industries GmbH  
Ruhberg 14  
D-35463 Fernwald-Steinbach  
P.O. Box 67  
D-35461 Fernwald-Steinbach

Tel. + 49 6404 9171-0  
Fax. + 49 6404 9171-40  
Internet: [www.tbi-industries.com](http://www.tbi-industries.com)  
E-mail: [info@tbi-industries.com](mailto:info@tbi-industries.com)